

COURTYARD AND STAGE

- 1 Lobby
- 2 Courtyard
- 3 Stage - Cupola
- 4 The Treasure Room: Paintings by Salvador Dalí

- A Down to the Ground Floor (Rooms 5 to 9)
- B Up to the 1st Floor (Rooms 10 to 22)
- C Up to the Stage (Room 3)
- D Access to the Courtyard
- Consignment Office. Deposit of personal articles only

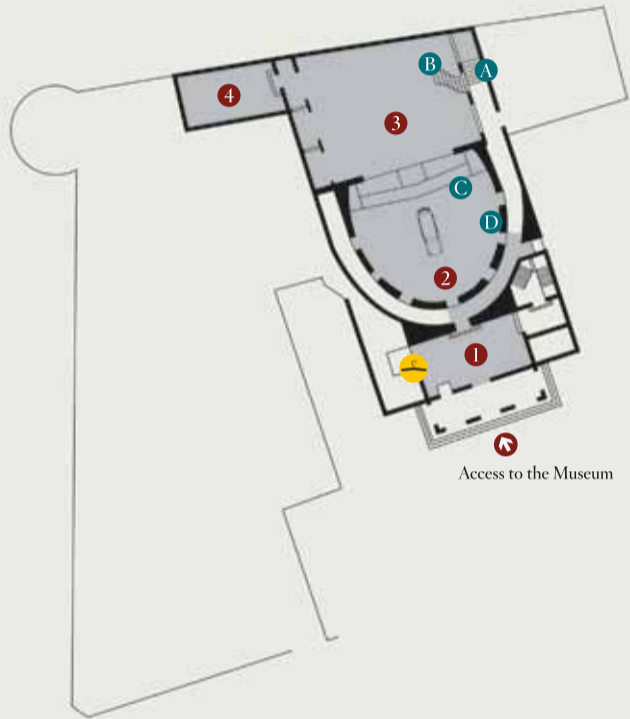

GROUND FLOOR AND BELOW STAGE

- 5 Fishmonger's Hall: Works by Salvador Dalí
- 6 "Dalí d'Or" Room: Drawings by Salvador Dalí
- 7 Crypt: The tomb of Salvador Dalí
- 8 Corridor: Works by Evarist Vallès
- 9 Corridor: Montages and graphic art by Salvador Dalí

- E Up to the Stage in order to go to the 1st Floor (Rooms 10 to 22)
- Toilets

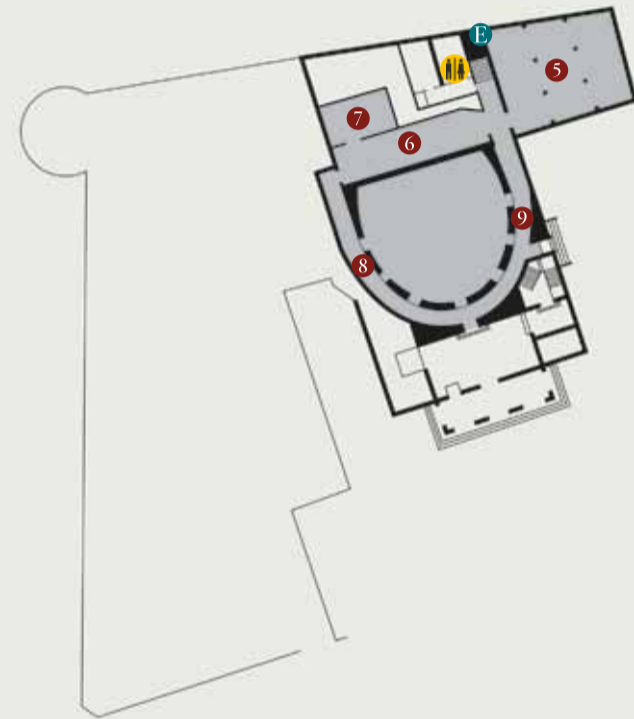

FIRST FLOOR (FIRST PART)

- 10 Corridor: composition by Salvador Dalí
- 11 Mae West Room

- F Up to the 2nd and 3rd floors (Rooms 12, 13 and 14)

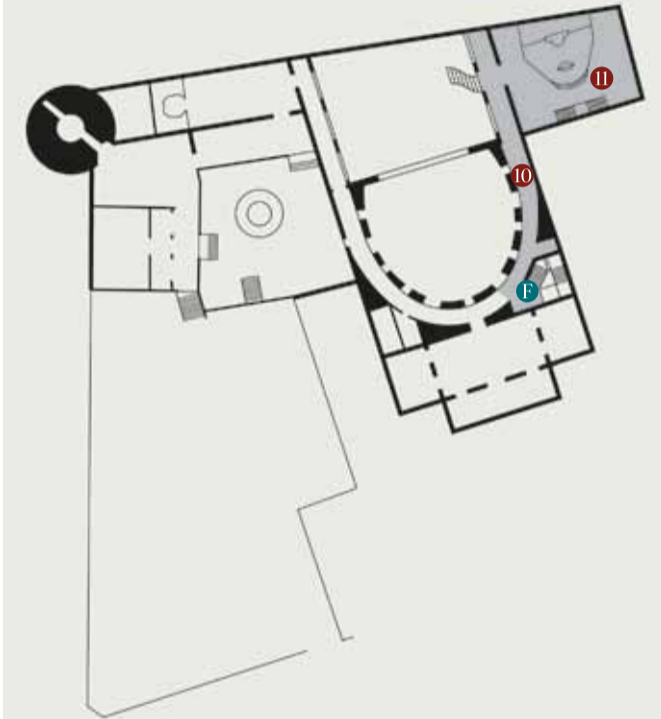

- 15 "Palace of the Wind" Room: works by Salvador Dalí
- 16 "Poetry of America" Room: works by Salvador Dalí
- 17 Corridor: montage by Salvador Dalí
- 18 "Bramante's Temple" Room: montage by Salvador Dalí
- 19 Loggia: Optical games and stereoscopies
- 20 Optical illusions Room: paintings by Salvador Dalí
- 21 "The tower of All the Enigmas": work by Salvador Dalí
- 22 The room of the "Quant cau, cau...": paintings by Salvador Dalí

- I Down to the exit
- Consignment Office. Only for the collection of personal articles
- Shop

FIRST FLOOR (SECOND PART) AND EXIT

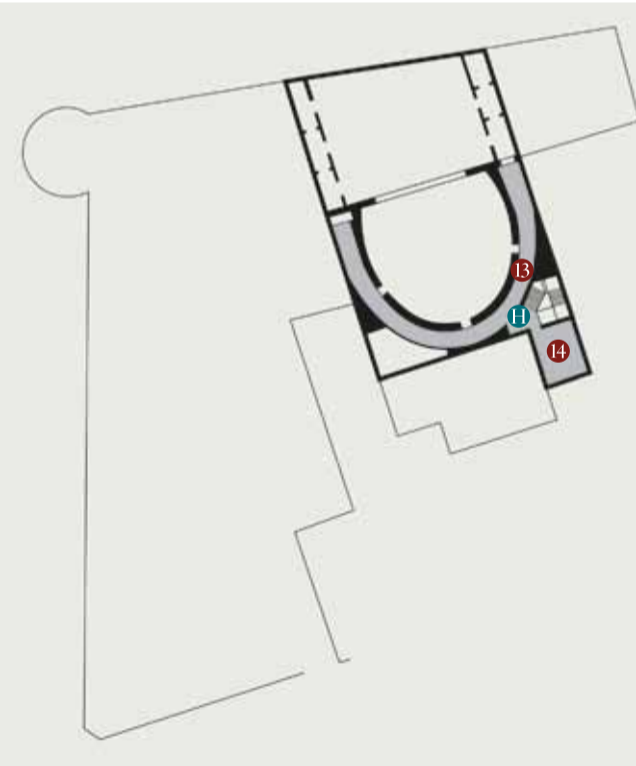

- 13 "Rue Trajan" corridor: works and montage by Salvador Dalí
- 14 Masterpiece Room: part of the private art collection of Salvador Dalí

- H Access to Rooms 13 and 14
Down to the 1st floor

THIRD FLOOR

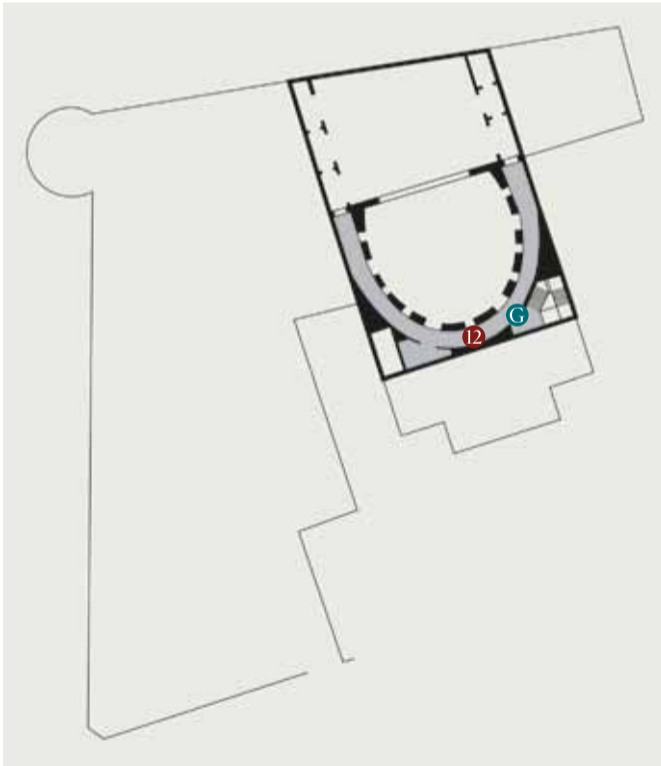

- 12 Area with paintings by Antoni Pitxot preceded by a montage by Salvador Dalí

- G Access to Room 12
Up to the 3rd floor (Rooms 13 and 14)

SECOND FLOOR