

COURTYARD AND STAGE

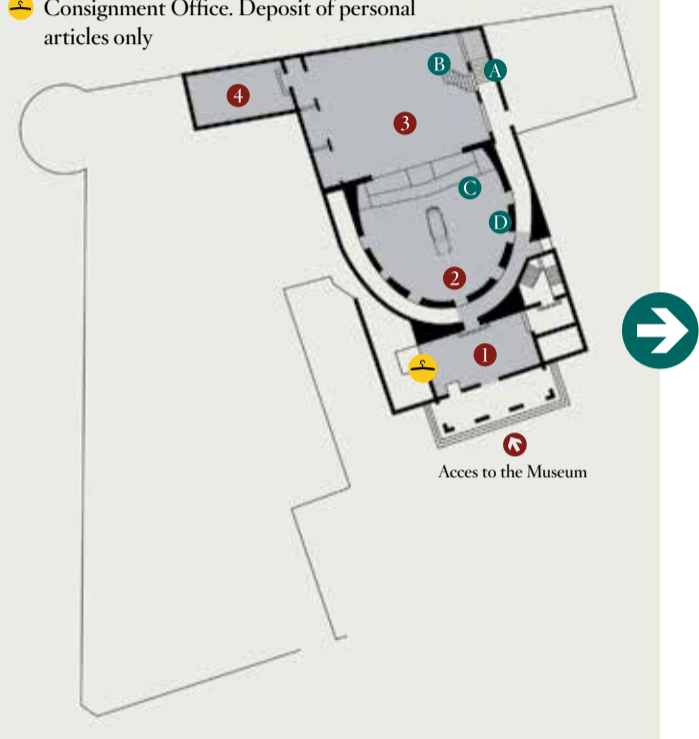

- 1 Lobby
- 2 Courtyard
- 3 Stage - Cupola
- 4 The Treasure Room: Works by Salvador Dalí

- A Down to the Ground Floor (Rooms 5 to 9)
- B Up to the 1st Floor (Rooms 10 to 22)
- C Up to the Stage (Room 3)
- D Access to the Courtyard
- Consignment Office. Deposit of personal articles only



GROUND FLOOR AND BELOW STAGE



- 5 Fishmonger's Hall: Works by Salvador Dalí
- 6 "Dalí d'Or" Room: Drawings by Salvador Dalí
- 7 Crypt: The tomb of Salvador Dalí
- 8 Corridor: Works by Evarist Vallès
- 9 Corridor: Installation and graphic art by Salvador Dalí

- E Up to the Stage in order to go to the 1st Floor (Rooms 10 to 22)
- Toilets

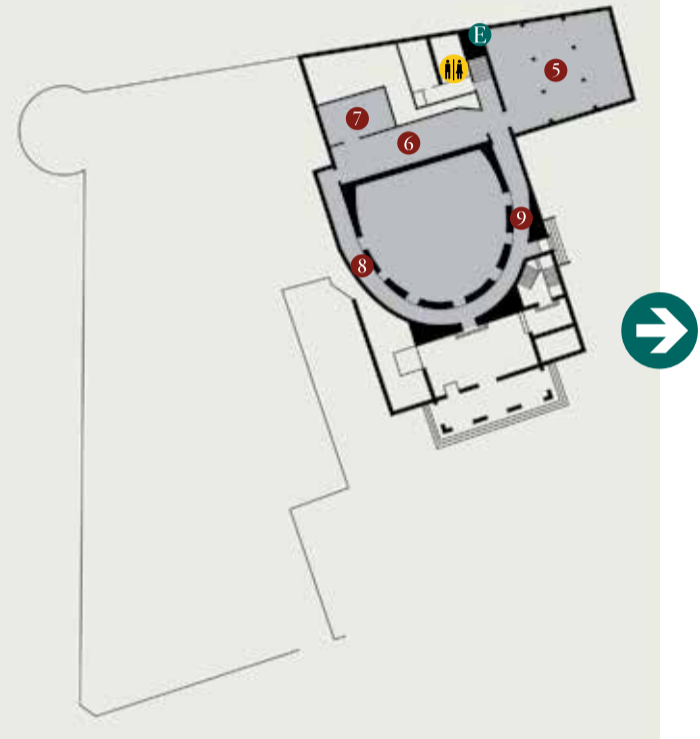

FIRST FLOOR (FIRST PART)



- 10 Corridor: installation by Salvador Dalí
- 11 Mae West Room

- F Up to the 2nd and 3rd floors (Rooms 12, 13 and 14)

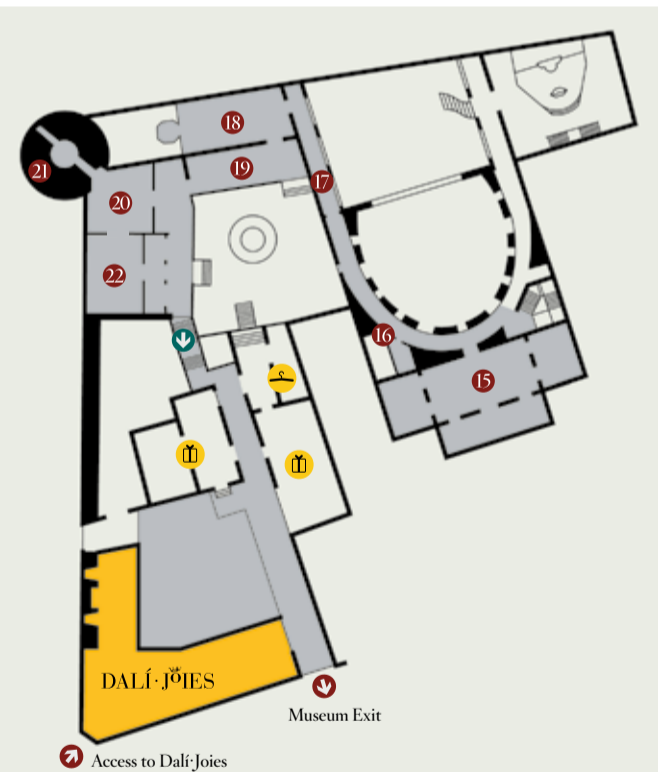
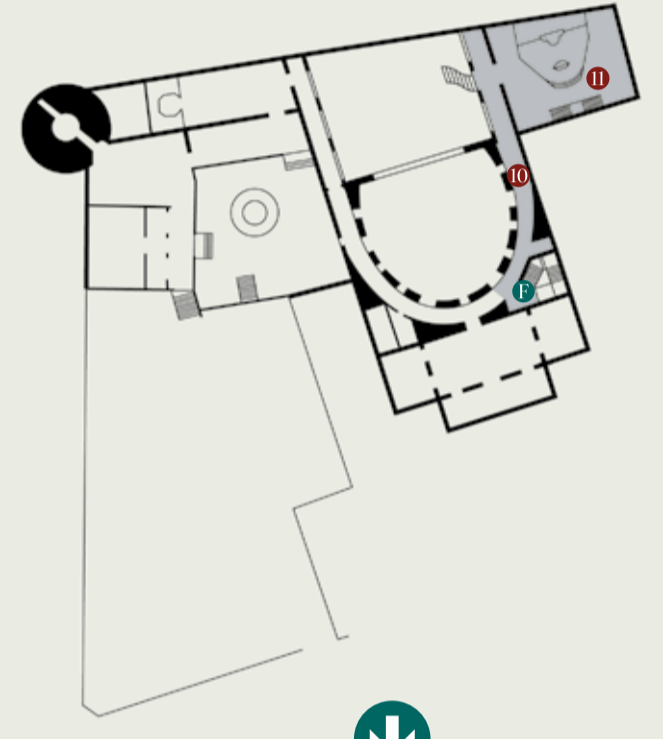

- 15 "Palace of the Wind" Room: works by Salvador Dalí
- 16 "Poetry of America" Room: works by Salvador Dalí
- 17 Corridor: installation by Salvador Dalí
- 18 "Bramante's Temple" Room: installation by Salvador Dalí
- 19 Loggia: Optical games and stereoscopies
- 20 Room 1 of the loggia area: Works by Salvador Dalí
- 21 "The tower of All the Enigmas": work by Salvador Dalí
- 22 Room 2 of the loggia area: "Elective Affinities"

- Down to the exit
- Consignment Office. Only for the collection of personal articles
- Shop

FIRST FLOOR (SECOND PART) AND EXIT

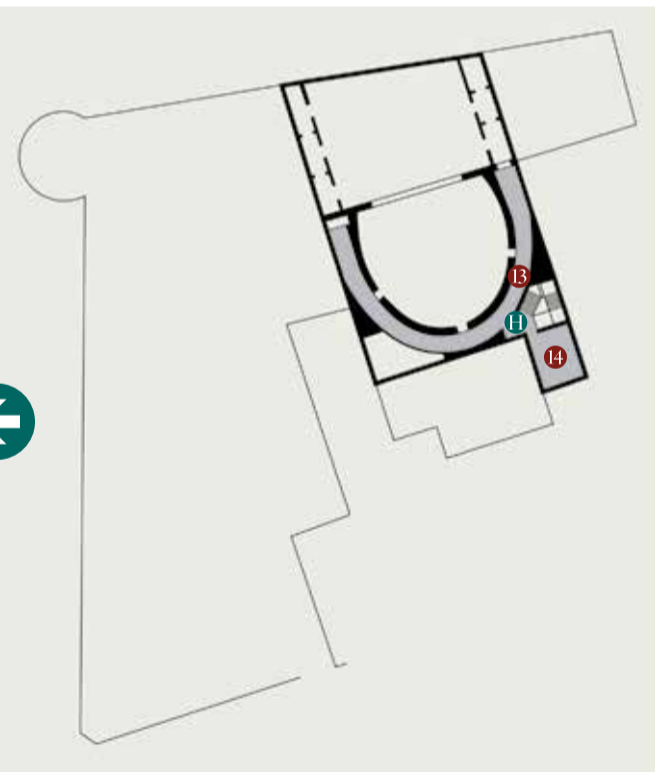

- 13 "Rue Trajan" corridor: works and installation by Salvador Dalí
- 14 Masterpiece Room: part of the private art collection of Salvador Dalí
- Access to Rooms 13 and 14 Down to the 1st floor

THIRD FLOOR

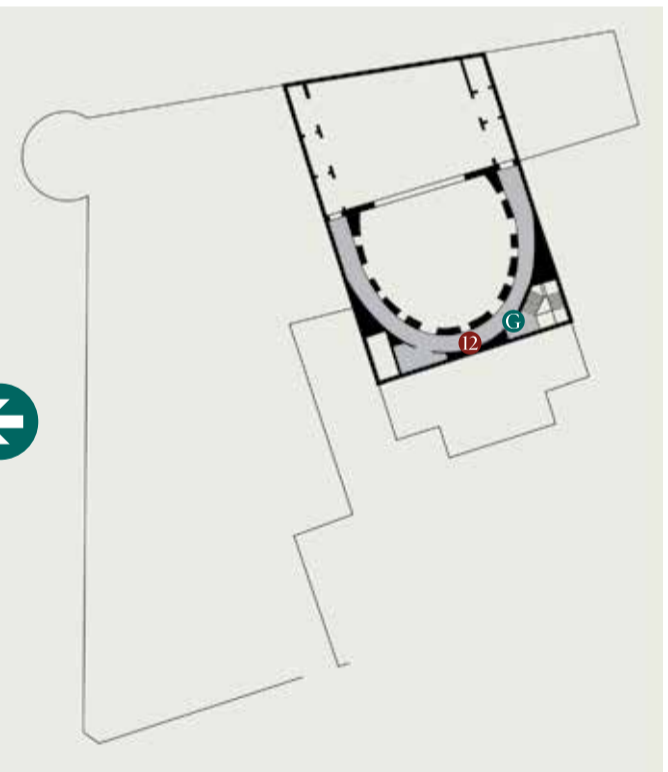

- 12 Area with works by Antoni Pitxot preceded by an installation by Salvador Dalí
- Access to Room 12 Up to the 3rd floor (Rooms 13 and 14)

SECOND FLOOR





© Salvador Dalí, Fundació Gala Salvador Dalí, VEGAP, Figueres 2006
 © Fundació Gala Salvador Dalí, Figueres 2006
 © Jordi Puig, Fundació Gala Salvador Dalí, Figueres 2006
 © Miquel Casals, "Medit", Fundació Gala Salvador Dalí, Figueres, 2006
 Image rights of Salvador Dalí reserved. Fundació Gala Salvador Dalí, Figueres 2006

- The exhibition rooms will start to close 15 minutes before the official closing time.
- Rucksacks, other shoulder bags and prams are not admitted.
- Visitors to the Theatre-Museum are requested to deposit all bags, umbrellas, luggage and other large objects in the consignment office.
- Smoking, eating and drinking in the Theatre-Museum is forbidden.
- It is forbidden to touch any of the works or settings exhibited.
- No flash photographs may be taken.
- The Management reserves the right to refuse admission.
- There are official forms available to the public in the entrance hall for making suggestions.

IMPORTANT!

A warning!
 If we take into account the idiosyncrasy of Salvador Dalí, the origin of the Dalí Theatre-Museum, then perhaps we ought to recommend you not to follow a preconceived route. However, despite this a one way route has been laid out. This only has the intention of guiding the visitor from the entrance to the exit without his missing any part of the Theatre-Museum. It does not have, nor does it wish to have, any systematic function nor chronological sense.

A description of the route
 The route covers 22 rooms which are numerically numbered in the order of the visit.

The visit starts in **ROOM 1** (entrance hall), continues to **ROOM 2**, then to **3**, **4**,... and so on until reaching **ROOMS 22** on the First Floor from where one can go down to the **SHOP**, the **CONSIGNMENT OFFICE** and to the only **EXIT** of the Theatre-Museum.

A VISIT TO THE DALÍ THEATRE-MUSEUM

The Dalí Theatre Museum, the largest surrealist object in the world, occupies the building of the former Municipal Theatre, a XIX century construction which was destroyed at the end of the Spanish Civil War. On its ruins Salvador Dalí decided to create his museum. "Where, if not were in my own city, should the most extravagant and solid examples of my art remain, where else? The Municipal Theatre, or what was left of it, seemed to me to be very appropriate for three reasons: first, because I am an eminently theatrical painter; second, because the Theatre is in front of the church where I was baptized and third, because it was precisely in the lobby of the Theatre that I had my first exhibition of paintings".

THE DALÍ THEATRE-MUSEUM

The Dalí Theatre Museum includes two museum areas:
 - The first is formed by the old burnt out theatre converted into a Theatre-Museum in accordance with the criteria and design of Salvador Dalí himself (**ROOMS 1 TO 18**). This space is a unique art object where each part is an intrinsic part of the whole.
 - The second is the complex of rooms formed as a result of the progressive extensions of the Theatre-Museum (**ROOMS 19 TO 22**).

The works of art on display
 The Theatre-Museum has a wide panorama of works which trace the artistic progress of the painter from the Empordan, starting from his artistic experiences – impressionism, futurism, cubism, etc... – and his own surrealist creations to the works of the last years of his life. All of it contained in an ambience created by Dalí according to his own aesthetic parameters.

Whilst the works of art on display are mainly Dalí's (paintings, drawings, sculptures, settings, etc...) there are also works by other artists:
 - Antoni Pitxot (**ROOM 12**),
 - Evarist Valles (**ROOM 8**),
 - Salvador Dalí's private collection: Greco, Fortuny, Uggell, Meissonier, Duchamp, Dou, Bouguereau (**ROOM 14**).

Additionally, in various rooms of the Theatre-Museum there are works by Bouguereau, John de Andrea, Meiffren, Ernst Fuchs, Silvere Godere and Olivier Brice amongst others.



VISIT SALVADOR DALÍ'S STUDIO AND CASTLE



CASTELL GALA DALÍ. PÚBOL



CASA SALVADOR DALÍ. PORTLLIGAT



Teatre-Museu Dalí
 Plaça Gala-Salvador Dalí, 5
 E-17600 Figueres
 Tel: +34 972 677 500
 E-mail: reserves@fundaciodalí.org

www.salvador-dali.org

ENGLISH MAP



TEATRE MUSEU DALÍ FIGUERES